



breeze®

Easy setup, maintenance, & transition

Pointers (not the laser kind, sorry) for cats and their humans

The Bigger Breeze



The Breeze



The Covered Breeze



Set-up instructions for humans

Getting started with your Breeze system.



The Breeze

- Place the grate in the base
- Snap the sidewall onto the grated base

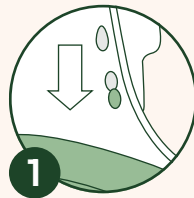

The Covered Breeze

- Assemble the hood by sliding the pegs in the lower set of openings on each side of the hood base & pushing them down until they click
- Place the grate in the base, then snap the hood onto the base

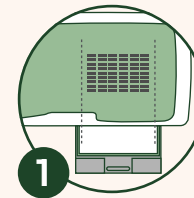
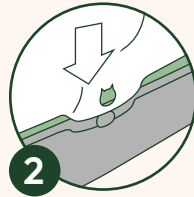

The Bigger Breeze

- With the drawer side facing you, place the grate in the base (ensuring the grate is directly above the drawer so it can funnel urine)
- Place the sidewall on top of the base, with the opening facing you (it sits to the left of the drawer)

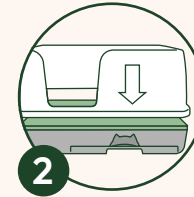

i Quick Tip: Cat behaviorists recommend that multiple-cat households have multiple litter boxes in different locations—one system per cat, plus one additional system (2 cats = 3 litter systems).

Maintenance instructions for humans

Now that your box is ready to go, time to put it to use:



Slide

Place 1 Ion Pad™ soft side up and flat in the drawer, and slide into base.



Fill

Pour one 3.5lb bag (1 month supply) of Zeolite Pellets into top portion.

Note: The Bigger Breeze requires two 3.5lb bags or one 7 lb bag.



Scoop

Remove and dispose of solids daily.

Note: Zeolite Pellets do not clump.



Rotate

Slide out and turn drawer for a no-touch way to extend Ion Pad™ life.



Replace Ion Pad™

Pull drawer out for low-touch weekly disposal. Put a fresh pad in drawer and re-insert.



Replace Zeolite Pellets

Add Zeolite Pellets as needed. We recommend replacing completely once a month.



Helping your cat embrace change

Cats can be picky, but switching litter systems is simple with the right approach. Our cat behavior experts put together these easy steps to help you both.

1 Introduce Zeolite Pellets first

Changing one thing at a time will help your cat ease into Breeze. Start by mixing up to a full 3.5lb bag of Zeolite Pellets into their current litter and litter box.

2 Bring in Breeze

Once your cat has given Zeolite Pellets their purr of approval, set up the Breeze box next to their current litter box. If their old box doesn't have high sides or a top, remove Breeze's sides or hood for now—this will help it feel more familiar.



3 Stop scooping

Stop cleaning your cat's old litter box—but don't toss it yet! Cats like cleanliness, so this will make Breeze the more appealing box. If they're hesitant to use it, scoop some clumps and poop from the old box into Breeze to help your cat recognize their new bathroom.

4 Keep it clean

Once your cat starts using Breeze, remove all solid waste promptly to encourage them to *keep* using it.

5 Ditch the old box

Now that your cat's doing all their business in Breeze, it's time to say goodbye to their old litter box.

i Quick Tip: Be patient! While most cats will transition within a week, some can take as long as a month to get comfy. Don't force your cat into Breeze, as this might frighten them and, ultimately, encourage them to avoid it.



Love Breeze or get
your money back.

If either of you are unhappy, we'll refund your money. Send the original UPC from your system, original receipt, your name, address and a brief reason why it wasn't right.

Nestlé Purina PetCare
PO Box 340
Neenah, WI 54957
Learn more at
breezeforcats.com

We're here to help!



Call
1-877-982-HELP to
chat with a cat
behavior pro, or scan
the QR code for
more expert input.